

08/2025

Rigid Click 30 / Rigid Click 55

Class 23/31 : the **Rigid Click 30** collection is designed for :

- Heavy domestic use : bedrooms, living rooms, kitchens, entrances, ...
- Commercial use, moderate traffic : hotel rooms, small offices, ...



Class 23/33 : the **Rigid Click 55** collection is designed for :

- Heavy domestic use : bedrooms, living rooms, kitchens, entrances, ...
- Heavy commercial use : classrooms, small offices, hotels, boutiques, ...



LVT collections can be installed in bathrooms without drain and slope in the subfloor but are not suitable for saunas, verandas/winter gardens or outdoor use.

For a fast installation and a perfect result that fulfils the warranty conditions, we advise to follow the below mentioned installation instructions carefully. Please also refer to local rules which may vary by country.

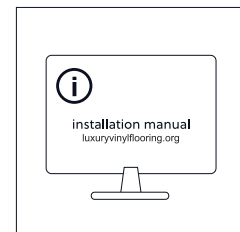

1. Planning your installation

Store and transport the boxes on a flat surface in neat stacks (never store the boxes upright). Keep the product in the box during acclimatisation, stacked max. 5 boxes high. Store the boxes inside at the temperature conditions close to those of the planned usage (18-25°C). Do not leave the boxes in very cold, very warm or humid places.

It is important to store the boxes closed for minimally 24 hours or at least until reaching the room temperature (18-25°C) before installation. This temperature should be maintained throughout the installation and for at least 24 hours after installation. Temperature fluctuation during installation will make the installation process more difficult.

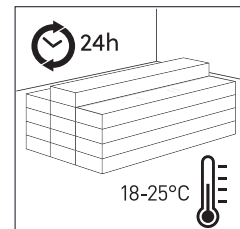

We highly recommend keeping one end-label of the boxes along with the receipt, as it contains important information about the production date and decor. Additionally, ensure that only one production batch is used for each individual room or area.

A floor is considered an interior product and should be treated accordingly, both during and after installation. To prevent any damage, the floor installation should be one of the final operations in the project. Ensure that the building's ventilation system is functioning properly. Additionally, cover the floor if any further work is required after installation.

LVT Click 2G

Installation manual

luxury
vinyl flooring

Tools

LVT Click 2G requires no special tools for installation, but we recommend that the following items are available on site :

- Trimming/utility knife (alternatively, a saw or guillotine may allow for faster work)
- Pencil
- Carpenter square, sliding bevel
- Measuring tape
- Spacers (wedges)

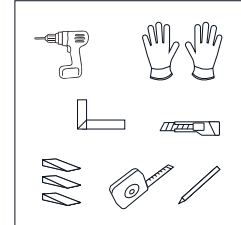

For your safety, wear gloves to protect your hands when cutting the planks/tiles.

No T-profiles are needed unless in the following situations:

- When the length or width of the installation area exceeds the recommended dimensions.
- Room temperature : 5-25°C : 30x30m
- Room temperature : 5-40°C : 15x15m
- When there is a construction joint in the building.
- When there are multiple underfloor heating circuits or when there are multiple underfloor heating circuits that could be used separately.

NB : Avoid exposure to extreme temperatures by using curtains and blinds.

For larger areas, an expansion profile must be used.

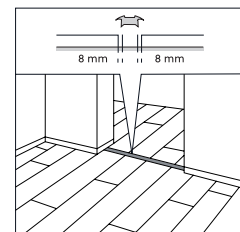
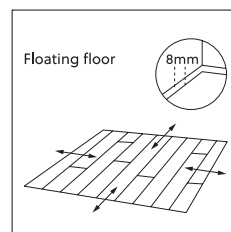
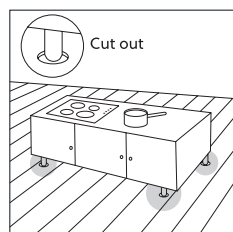
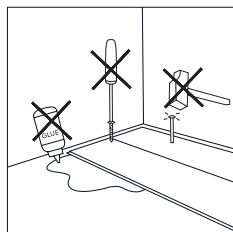

LVT Click 2G is a floating floor and must be able to move freely:

- Do not screw or glue the planks/tiles to the subfloor.
- Avoid installing fixed structures, such as kitchen cabinets or built-in closets, on top of the floating floor.
- The weight of the object (once attached to the wall) should rest solely on the subfloor.
- Leave an 8 mm expansion gap around walls and other fixed structures to allow the flooring to expand and contract.

Advice : separate the bathroom from the rest of the rooms with an expansion profile.

T-profiles in doorways are recommended in case of high temperature difference (above 10°C) between 2 adjoining rooms.

LVT Click 2G must be able to move around fixed structures to prevent gaps or separation at the locks. This can be achieved using one of two methods:

- Install the fixed structures first, followed by the installation of LVT Click 2G around the objects.
- Install LVT Click 2G first, then install the fixed structures. Mark the floor where the objects will be placed and create holes for any fixed structures or furniture legs. Alternatively, an expansion joint can be created around the perimeter of the object by sawing through the area underneath.

2. Preparing the sub loor

LVT Click 2G can be installed on most hard, non-tacky and non-porous subfloors (such as chipboard, OSB, plasterboard, or concrete/screed, ...).

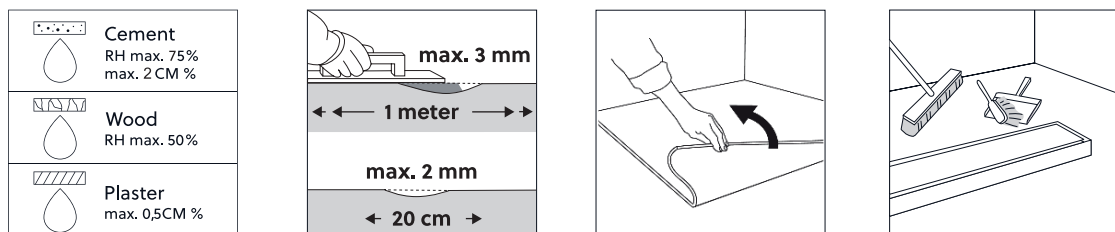

The subfloor must be completely dry when installing on :

- Wooden and wood-based material, max. 50% relative humidity
- Concrete and screed, max. 75% relative humidity or 2,0 CM % (1,8 CM % if floor heating)
- Plaster and plaster-based floor, max. 0,5 CM % (0,3 CM % if floor heating)
- In case of any specific local or national guidelines, these are to be followed.

Careful subfloor preparation is essential for a good result. Roughness or unevenness in the subfloor may telegraph through the new floor, resulting in an unsightly surface and causing excessive wear on high spots or indentation on lower spots. In any case, the subfloor must be clean, even, dry, stable and free of cracks. Remove all traces of plaster, paint, glue, oil, grease, debris (including nails), etc. and vacuum.

Remove any soft floor coverings (such as carpet, needle felt, cushion vinyl, linoleum, cork, etc.). The planks or tiles can be installed over concrete, screed, tiles, wood, and most existing hard surface floor coverings. If the moisture level is above the specified values, actions should be taken to reach those values prior to installation and apply a moisture barrier. Excessive moisture can lead to mould or fungus growth. Ensure that floor level deviations do not exceed 3 mm over 1 meter and 2 mm over a 20 cm length. If these limits are exceeded, the subfloor must be levelled with a suitable filler or levelling compound, and it should be checked to determine if a sealer is necessary.

Specific preparation depending on the type of subfloor

- Concrete/screed : Let new concrete dry sufficiently. Always record and keep your moisture content results.
- Tiles : Check the subfloor for moisture problems. The joints of the new floor covering should never be aligned with the underlying tile joints. It is not necessary to fill the grouts of a subfloor comprised of ceramic tiles with joints when these do not exceed 5 mm in width. Bear in mind that some ceramic tiles may show rising edges/corners although the main level may be correct. These parts may telegraph through the floor covering in the future.
- Wood : Check the floor for insect infestations. Make sure the subfloor is levelled and screw down any loose sections firmly. Wooden subfloors should always have access to air and should be ventilated at the edges. If there is any moisture in the wood-based subfloor or there is no proper moisture barrier below the wood-based subfloor, it must be removed first.
- Raised floor : LVT Click 2G cannot be installed over a raised floor.

If uncertain about the quality or suitability of your subfloor for the installation of the planks/tiles, then contact your dealer, who will be more than happy to help you.

3. Underfloor heating / cooling

The planks/tiles are compatible with underfloor heating, provided that the temperature on the surface of the floor covering does not exceed 27°C. With electrical underfloor heating, we recommend not exceeding 90W/m².

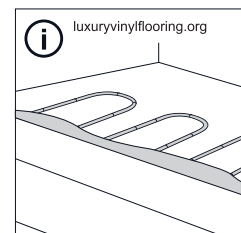

The planks/tiles can also be installed over floor cooling systems. However, the supply temperature of the cooling water must not be reduced to below the dew point temperature. If the temperature goes below this dew point condensation can cause damage to the floor. Thermostats in the room must never be set at a temperature that is more than 5°C lower than the room temperature.

For more detailed instructions on underfloor heating, including electric and waterborne systems, please read the underfloor heating manual on our website.

4. Underlays

Since LVT Click 2G products come with an integrated underlay, no additional underlay is permitted, except for the moisture barrier.

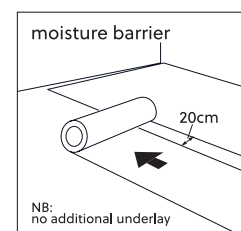
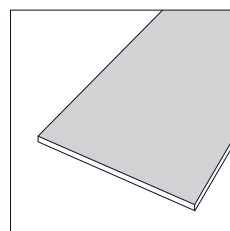

5. Getting started

Direction of the planks/tiles : the floor will look at its best if installed parallel to the incoming light (short side facing the light).

Measure the length of the room from the point where the installation is planned to start to the wall where it will end. Divide this by the width of a plank/tile. The purpose is to never end with a plank/tile that is less than 5 cm wide. If that is the case, modify the width of the first row (cut the plank/tile so the installation doesn't start with a full width plank/tile, but it should be more than 5 cm).

Check all planks/tiles for visible defects in optimal light conditions, both before and during installation. Planks/tiles with defects must not be used. A defective plank/tile that has been installed is considered accepted and will not be accepted as the cause of a claim after the installation is completed. During installation inspect the groove and remove any debris that may prevent the proper assembly of the planks/tiles.

For the most natural appearance, be sure to mix the designs of the planks or tiles across the floor. When installing, the end joints should be staggered by at least 1/3 of the length of the plank or tile. We recommend that the first and last plank or tile in each row be at least 10cm.

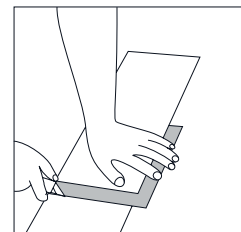
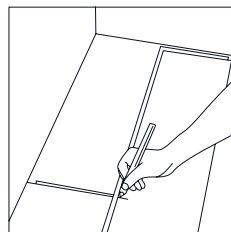
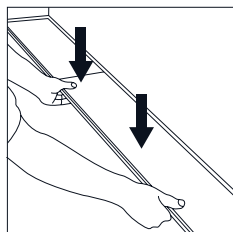
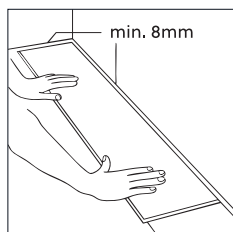
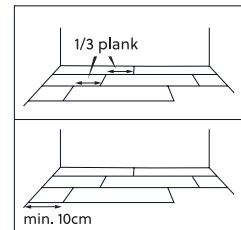
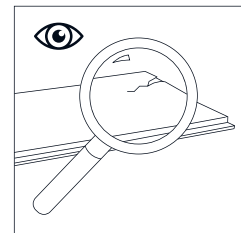
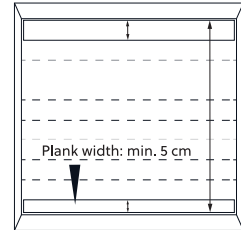

Start in the top left corner, placing the plank or tile with the locking profiles facing the room, and install towards the right. Ensure a tight connection on the short side between the planks or tiles. Continue installing the remaining planks or tiles in the same row in the same manner. Leave an 8 mm gap between the plank or tile and the wall (use spacers). The 8 mm expansion gap between the long side and the wall can be adjusted after 2 rows have been installed.

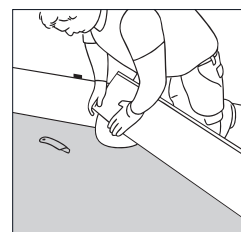

Finishing the row: place the final plank or tile face down (locking profiles facing the room), with the short side positioned 8 mm from the wall. Mark where the plank or tile needs to be cut. Place the plank or tile face up and cut it using a sharp utility knife and a square. Score the surface with the knife and then snap the plank or tile along the score line. Turn the cut piece around and connect it to the short side of the previous plank or tile.

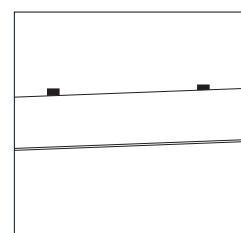

6. A quick and easy installation

The Click 2G system is extremely easy and fast, which allows installing planks/tiles with no specific tool.

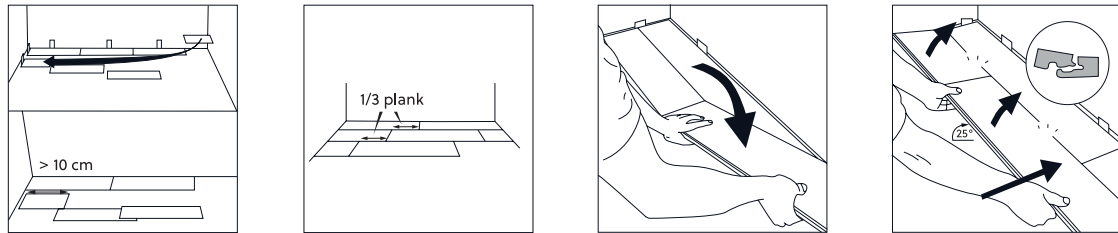

Position the remaining part of the last plank/tile of the first row as the first plank/tile in the second row. The minimum distance between short ends of planks/tiles in parallel rows shall not be less than 1/3 of the length of the plank/tile. Place the plank/tile at an angle against the plank/tile in the previous row, press forward and fold down at the same time. Leave the panel in a somewhat up-angled position so that the panels start to lock. To make this even easier, a wedge with the suitable angle can be placed under the plank near the short side joint as support.

Place the short end of the next plank/tile at an angle against the previously installed plank/tile and fold down all the way. Lift the row and push to slide the plank/tile against the row in front so it aligns with the first plank/tile. Put it down as with the first plank/tile when the floorboards are positioned tightly together. The first/previous plank/tile can now be folded down completely to a horizontal position and, if a wedge is used, it can be moved to the next short end joint.

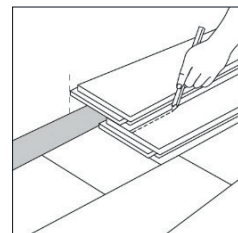
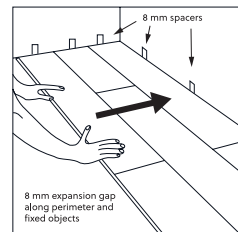

To install the last row, position a plank/tile exactly on top of the previous row. Place another plank/tile upside down up to the wall and mark the plank/tile underneath, adding an 8-10 mm expansion gap. Cut the marked plank/tile to size and fit in place. This method should be repeated for each plank/tile until the last row is complete.

As LVT Click 2G is installed following the floating method, it can be used immediately after installation.

Pipes/columns

Drill holes in the plank/tile, the diameter of the hole must be 8 mm larger than the diameter of the pipe. For fixed installations, like pipes, cut out the necessary piece in an angle of 45°. Glue the cut piece back into position and cover with pipe sleeves.

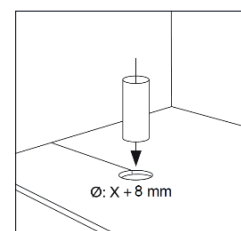

Door frames

We strongly recommend adjusting the door frames to allow installation of the floor underneath the frames (to allow free movement and achieve a good overlap with the floor). During the sawing, use a piece of plank/tile as a support (turned upside down) when modifying the door frames to the correct height (see illustration).

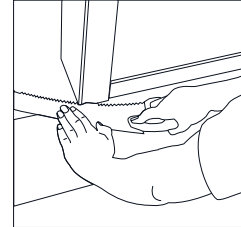

Stair railing/other screwed objects

We recommend installing a wooden plank (slightly thicker than the floor) before fastening the stair railing/other screwed objects to the subfloor (see illustrations). This will allow free movement and achieve a good overlap with the floor.

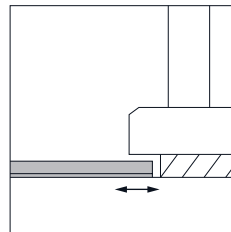
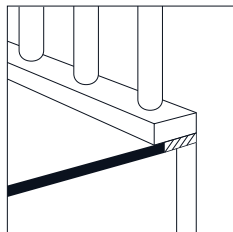
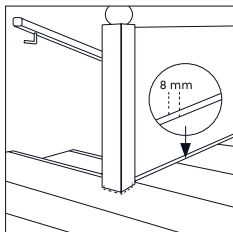

NB : Do not fill expansion gaps completely with sealant.

7. A perfect finish

Skirtings and profiles can be used for the finishing touch.

When installing accessories, always remember that the floor must be able to move. This means:

- After installing a skirting or profile, avoid sealing or fixing it to the floor with sealant. The floor's movement will cause the sealant to crack, making it ineffective, unsightly, and prevent the floating floor from moving freely.
- Joints around fixed building elements (such as door frames, heating pipes, etc.) should never be completely filled with sealant.
- Thresholds, profiles, doorstops, and similar items should not be screwed through the floorboards into the subfloor.

LVT Click 2G

Installation manual

luxury
vinyl flooring

T-profile (incl. U-profile)

Fix the U-profile to the subfloor and leave a gap of 8 mm to the floor areas. Click the T-profile in place after having installed the complete floor. The floor areas have to be able to move freely.

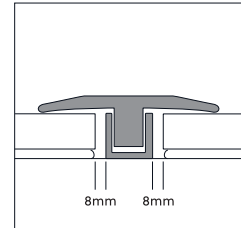

Skirting

Use clips when installing skirtings, to be able to remove them easily afterwards, if necessary. The clips should be placed with 50 cm intervals. Tip for cutting in corners: Support the skirting with clips on the backside when cutting, to make the correct angle on the skirting. The skirting can also be glued or nailed (with a high pressure brad tacker). Be careful not to glue or seal the skirting to the floor.

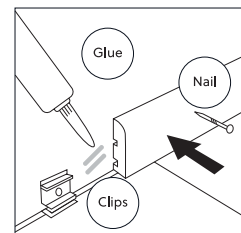

N.B. : Consider saving a few planks/tiles for any potential future repairs.

8. Care and maintenance

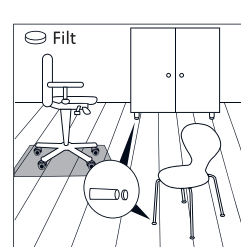
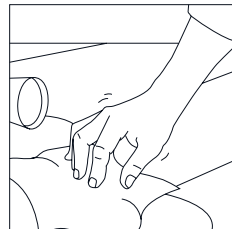
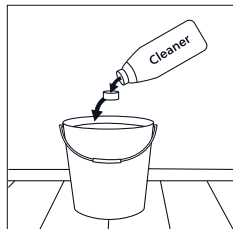
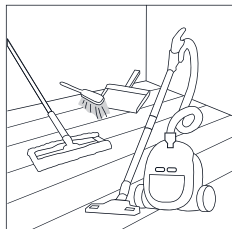

After installation it is required to maintain a room temperature of 18-25°C and a relative humidity level below 75% (optimum level 40-50%).

The LVT Click 2G floor is amazingly easy to clean :

- **Initial cleaning :** First remove all dirt and dust from the flooring with a brush or vacuum cleaner. Then clean with water and an appropriate neutral cleaning agent, at least twice and until the water stays clean.
- **Regular cleaning :** Vacuum or use a wet mop. As required, use a solution of clean water and mild detergent or domestic floor cleaning emulsion. Do not flood the floor or leave a puddle of water on the floor. Rinse thoroughly until the water stays clean and soak up residual water.

NB : Any unsuitable cleaning product may contain agents that damage resilient floor surfaces. The coating of the top-layer makes a specific treatment after installation unnecessary. LVT Click 2G cannot be polished or treated with products that contain wax or oil.

08/2025

NB : Any unsuitable cleaning product may contain agents that damage resilient floor surfaces. The coating of the top-layer makes a specific treatment after installation unnecessary. LVT Click 2G cannot be polished or treated with products that contain wax or oil.

Clean up any spilled liquids immediately and never use steam cleaners on LVT.

To keep your floor in good condition, it is important to place non-rubber backed doormats at all entrances, to prevent dirt or grit on your floor. The use of doormats will eliminate abrasive particles driven by footwear and will reduce damage. Do not use rubber-backed mats or rubber pads, as long-lasting contact with rubber can cause permanent discoloration. Never place doormats on a wet floor.

Rolling (office) chairs, furniture legs, home fitness appliances, etc. should be fitted with soft, non-rubber castors, to avoid permanent damage to your floor. Use a suitable desk mat.

We recommend the use of white felt pads or protective feet for items that contain rubber, such as chair legs, furniture legs, fitness appliances, etc. Use specific protection under heavy/sharp furniture to avoid indentation.

For more details, read our care and maintenance manual.

9. Warranty

By following the above mentioned instructions, the longevity of the LVT Click 2G will be extended and the validity of the warranty ensured.

We refer to our warranty conditions for more info.

Legal information

This document presents the general installation instructions, based on the latest available information. For the best result, and to ensure the validity of the guarantee, these instructions should be followed carefully. This document replaces all previous versions and is valid until further notice. This information is a representation of the technical knowledge at the time that this document was produced/published and may be amended, complemented, or replaced at any time. Please check the following website frequently for updates: www.luxuryvinylflooring.org