

05/2026

### GD 30 / GD 55 / GD 55 Herringbone

Class 23/31 : the **Glue Down 30** collection is designed for :

- Heavy domestic use : bedrooms, living rooms, kitchens, entrances, ...
- Commercial use, moderate traffic : hotel rooms, small offices, ...

Class 23/33/42 : the **Glue Down 55 and Glue Down 55 Herringbone** collections are designed for :

- Heavy domestic use : bedrooms, living rooms, kitchens, entrances, ...
- Heavy commercial use : classrooms, small offices, hotels, boutiques, ...
- General industrial use : storage spaces, assembly line, ...

**LVT Glue Down** collections can be installed in bathrooms without drain and slope in the subfloor but are not suitable for saunas, verandas/winter gardens or outdoor use.

For a fast installation and a perfect result that fulfils the warranty conditions, we advise to follow the below mentioned installation instructions carefully. Please also refer to local rules which may vary by country. Please also refer to local rules which may vary by country.

## 1. Planning your installation

Store and transport the boxes on a flat surface in neat stacks (never store the boxes upright). Keep the product in the box during acclimatisation, stacked max. 5 boxes high. Store the boxes inside at the temperature conditions close to those of the planned usage (18-25°C). Do not leave the boxes in very cold, very warm or humid places.

It is important to store the boxes closed for minimally 24 hours or at least until reaching the room temperature (18-25°C) before installation. This temperature should be maintained throughout the installation and for at least 24 hours after installation. Temperature fluctuation during installation will make the installation process more difficult.

We highly recommend keeping one end-label of the boxes along with the receipt, as it contains important information about the production date and décor. Additionally, ensure that only one production batch is used for each individual room or area.

A floor is considered an interior product and should be treated accordingly, both during and after installation. To prevent any damage, the floor installation should be one of the final operations in the project. Ensure that the building's ventilation system is functioning properly. Additionally, cover the floor if any further work is required after installation.

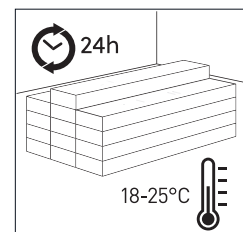
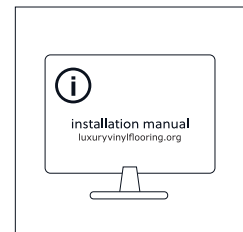

### Tools

LVT Glue Down requires no special tools for installation, but we recommend that the following items are available on site :

- Trimming/utility knife (alternatively, a saw or guillotine may allow for faster work)
- Pencil
- Carpenter square, sliding bevel
- Measuring tape
- Trowel
- Adhesive/glue

For your safety, wear gloves to protect your hands when cutting the planks/tiles.

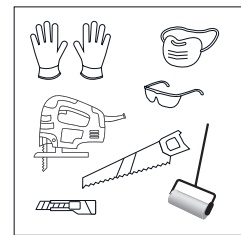
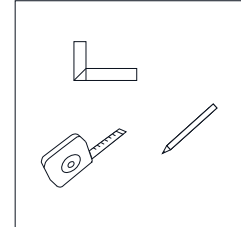

With a glued installation method, there are no length or width restrictions. Keep a distance to the walls (4 mm T-profiles are not necessary and fixed constructions can be placed directly on the planks or tiles (including kitchen cabinets).

Whenever there is a functional, constructional joint in the subfloor, or if there is an underfloor heating joint in the screed, it is required to use a T-profile nonetheless.

## 2. Preparing the subfloor

LVT Glue Down can be installed on most hard, non-tacky and non-porous subfloors (such as chipboard, plasterboard, or concrete/screed, ...).

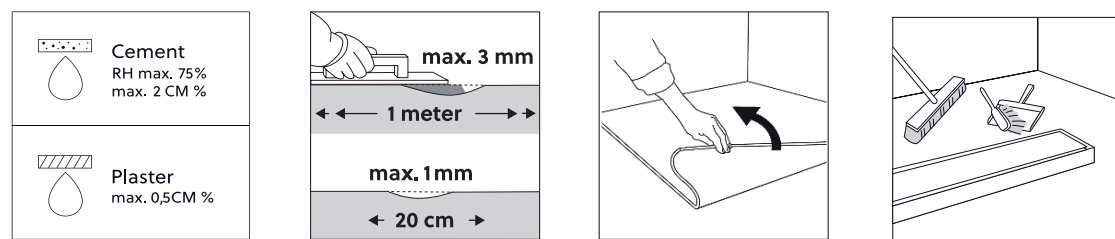

The subfloor must be completely dry when installing on :

- Concrete and screed, max. 75% relative humidity or 2,0 CM % (1,8 CM % if floor heating)
- Plaster and plaster-based floor, max. 0,5 CM % (0,3 CM % if floor heating)

In case of any specific local or national guidelines, these are to be followed.

Careful subfloor preparation is essential for a good result. Roughness or unevenness in the subfloor may telegraph through the new floor, resulting in an unsightly surface and causing excessive wear on high spots or indentation on lower spots. In any case, the subfloor must be clean, even, dry, stable and free of cracks. Remove all traces of plaster, paint, glue, oil, grease, debris (including nails), etc. and vacuum.

Remove any soft floor coverings (such as carpet, needle felt, cushion vinyl, linoleum, cork, etc.). The planks or tiles can be installed over concrete, screed, tiles, wood, and most existing hard surface floor coverings.

If the moisture level is above the specified values, actions should be taken to reach those values prior to installation and apply a moisture barrier.

Excessive moisture can lead to mould or fungus growth. Ensure that floor level deviations do not exceed 3 mm over 1 meter and 1 mm over a 20 cm length. If these limits are exceeded, the subfloor must be levelled with a suitable filler or levelling compound, and it should be checked to determine if a sealer is necessary.

### Specific preparation depending on the type of subfloor

- Concrete/screed : Let new concrete dry sufficiently. Always record and keep your moisture content results.
- Tiles : The glue down floor can only be installed on top of firmly levelled subfloor for all gaps between ceramic tiles will telegraph through. Installation directly on unlevelled top of ceramic tiles is not recommended.
- Wood : The glue down planks or tiles cannot be installed on most wooden substrates without special preparation. Either specific levelling compounds must be used, or the wood subfloor must be covered with special layers, e.g. plywood panels. These panels must be firmly attached to each other/the wood substrate and/or be glued or fixed. If there is any moisture in the wood-based subfloor or there is no proper moisture barrier below the wood-based subfloor, it must be removed first.
- Raised floor : LVT Glue Down cannot be installed over a raised floor.

If uncertain about the quality or suitability of your subfloor for the installation of the planks or tiles, then contact your dealer, who will be more than happy to help you.

## 3. Underfloor heating / cooling

The planks/tiles are compatible with underfloor heating, provided that the temperature on the surface of the floor covering does not exceed 27°C. With electrical underfloor heating, we recommend not exceeding 90W/m<sup>2</sup>.

The planks/tiles can also be installed over floor cooling systems. However, the supply temperature of the cooling water must not be reduced to below the dew point temperature. If the temperature goes below this dew point condensation can cause damage to the floor. Thermostats in the room must never be set at a temperature that is more than 5°C lower than the room temperature.

For more detailed instructions on underfloor heating, including electric and waterborne systems, please read the underfloor heating manual on our website.

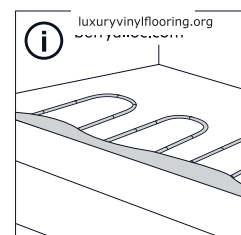

## 4. Underlays

Since LVT Glue Down products are installed fully glued, no additional underlay is permitted.

### 5. Getting started

Direction of the planks/tiles : the floor will look at its best if installed parallel to the incoming light (short side facing the light). The planks/tiles must all be installed in the same direction according to the arrows visible on the back side.

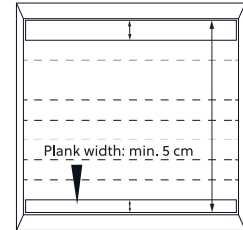

Measure the length of the room from the point where the installation is planned to start to the wall where it will end. Divide this by the width of a plank/tile. The purpose is to never end with a plank/tile that is less than 5 cm wide. If that is the case, modify the width of the first row (cut the plank/tile so the installation doesn't start with a full width plank/tile, but it should be more than 5 cm).

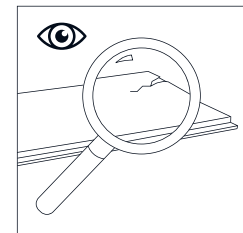

Check all planks/tiles for visible defects in optimal light conditions, both before and during installation. Planks/tiles with defects must not be used. A defective plank/tile that has been installed is considered accepted and will not be accepted as the cause of a claim after the installation is completed. During installation remove any debris that may prevent the proper gluing of the planks/tiles.

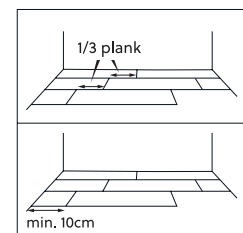

For the most natural appearance, be sure to mix the designs of the planks or tiles across the floor. When installing, the end joints should be staggered by at least 1/3 of the length of the plank or tile. We recommend that the first and last plank or tile in each row be at least 10 cm.

We recommend you dry fit the planks/tiles (without glue) first, at least two rows

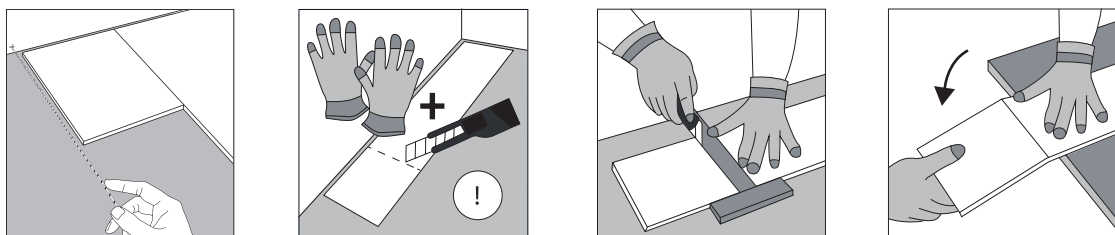

Start the first row with a whole plank in length. Make sure that the first rows are in a perfectly straight line. Your starting wall may be at a slight angle. You can check this by holding a thin rope and adjusting the straightness of your floor where necessary. Cut boards with a trimming knife, decor side up. When cutting the vinyl plank, mark the line and use the knife to make a firm cut in the surface.

## 6. Herringbone installation

The positioning of the pattern across the length and width can vary. Measure and calculate the area carefully and decide and mark before starting the installation the correct center- and/or reference lines. It is visually best when there is an equal pattern left and right, front and rear of the design in the main room/area.

### Step 1

Determine the installation direction of the herringbone planks. Calculate how the partition of planks will be across the width of the room/area and mark a 100% straight line on the floor.

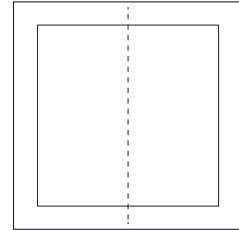

### Step 2

Highlight the second line so creating the section (for example, 5 rows wide) to be glued with the correct type of adhesive. The center line always runs through the middle of the short side of the plank.

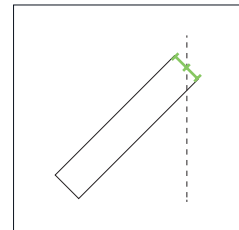

### Step 3

Spread the right amount of adhesive evenly over the subfloor and let it tack-off (open time) until it reaches its initial bonding strength. Place a support surface (with a perfect angle of 90°) at 45° so that the centre line runs through the centre of the top plank.

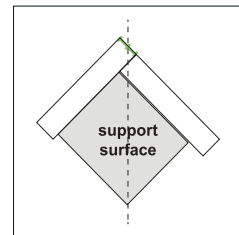

### Step 4

You can now draw 2 guiding lines that mark the area in which you are going to install. Lay the planks, observing the direction of the arrows of the backing, into the tacked-off adhesive.

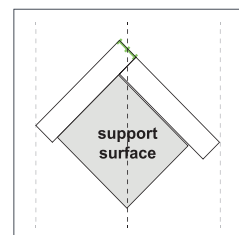

### Step 5

Now install the planks in the order as indicated above in a V shape. Always press well on the long side ensure that the 90° angle is maintained. Complete this line to the end of the room.

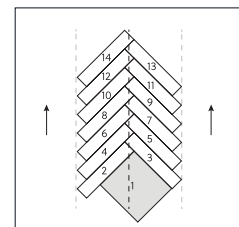

### Step 6

Now start on the other side and first of all install your supporting surface in 45°. Now place half of the V shape and work in the other direction. Always press well on the long side to be sure that the 90° angle is maintained.

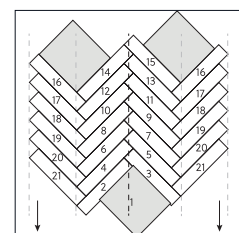

### Step 7

Immediately roll each section with a (minimum) 45kg flooring roller. Roll several times, in different direction, during the adhesive working time. Wipe excess adhesive with a damp cloth.

Repeat steps 3 to 6 until the entire installation is completed

### Pattern & design

With glue down products, different patterns can be followed for a unique floor design.

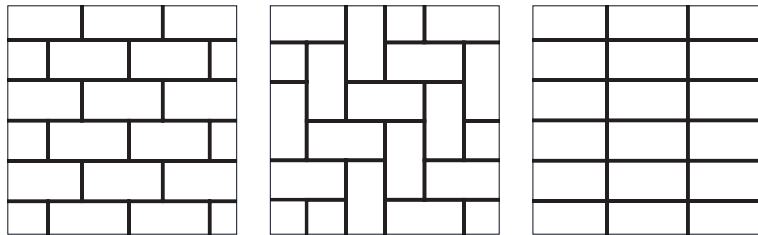

## 7. Recommended glues

BRAND	ADHESIVE	SPATULA	CONSUMPTION
<b>F. BALL</b>	<b>F44</b> Acrylic Adhesive	A1	250 g/m <sup>2</sup>
	<b>F46</b> Pressure Sensitive Acrylic	A1-A2	250-330 g/m <sup>2</sup>
	<b>F48+</b> High resistance to heat	A2	0,180 L/m <sup>2</sup>
	<b>F49</b> Tolerant of extreme temperature variations	A1	166 g/m <sup>2</sup>
	<b>F58+</b> Use as a wet lay, semi-wet or pressur sensitive adhesive	A2	0,166 L/m <sup>2</sup>
<b>ARDEX</b>	<b>AF175</b> Pressure sensitive	A2	260 g/m <sup>2</sup>
	<b>AF145</b> Pressure sensitive	A2	260 g/m <sup>2</sup>
<b>UZIN</b>	<b>UZIN KE 66</b> – for residential use	A2	280 g/m <sup>2</sup>
	<b>UZIN KE 68</b> – for areas with high traffic and high sunlight exposure	A5	250-300 g/m <sup>2</sup>
	<b>UZIN KE 2000 S</b> – for residential and commercial use	A1 A2	200-280 g/m <sup>2</sup> 250-320 g/m <sup>2</sup>
<b>MAPEI</b>	<b>Ultrabond ECO 4 LVT</b> best EU range	A1	250-350 g/m <sup>2</sup>
	<b>Ultrabond ECO VS 90 Plus</b> EU range	A1	250 g/m <sup>2</sup>
	<b>Ultrabond ECO V4 SP Fiber</b> EU range	A1 / A2	250 g/m <sup>2</sup> / 400 g/m <sup>2</sup>
	<b>Ultrabond ECO 360</b> US range	A1	185-245 sq. ft per US gal.
	<b>Ultrabond ECO 300</b> US range	A2	185-245 sq. ft per US gal.
<b>THOMSIT</b>	<b>K 188E</b>	A2	250-300 g/m <sup>2</sup>

**N.B. :** This approval does not exempt the product user from checking the suitability of the respective adhesive in advance under real conditions for the intended application and purpose. Please refer to supplier's technical datasheet to select the right glue for your use.

## 8. A quick and easy installation

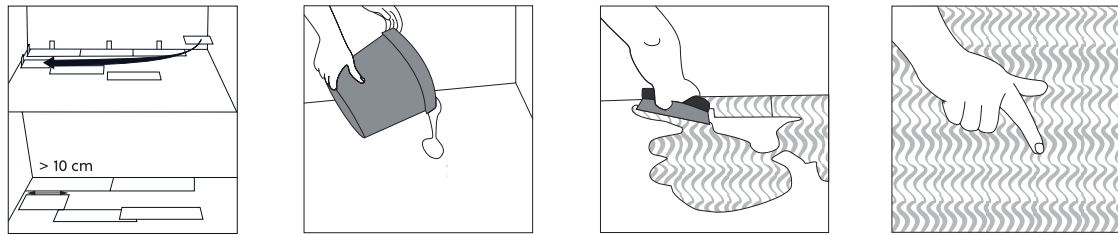

Remove the dry fitted panels, and store them one row at a time. Apply the glue on the floor according to the manufacturer's recommendations. Check the trowel for the correct notch size. Do not use worn trowels.

Divide your floor into different sections, make sure that the section is the right size: meaning that the planks/tiles can be installed on the adhesive within the glue's open time. Also respect the recommended amount of glue to be used. It is very important to check the recommendation for open/waiting time before you start gluing the planks/tiles (see point on recommended glues). Place the flooring into the adhesive.

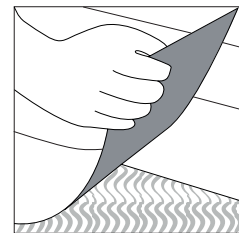

To install the last row, position a loose panel exactly on top of the last one laid. Place another panel upside down against the wall and mark the panel underneath. Cut the marked panel to size and fit in place. This method should be repeated for each panel until the last row is complete.

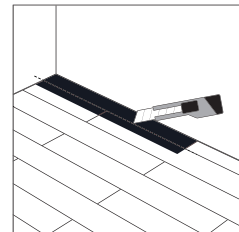

When a section is installed, the floor should be rolled in both directions with a floor roller that weighs around 45 kg to ensure a good adhesive transfer. All the glue residue should be removed immediately with a damp cloth. Never use detergents. Use the same procedure to complete the rest of the room.

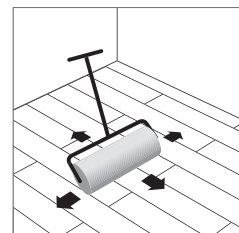

The glue must be allowed to cure 100% before moving in any furniture. Leave the floor untouched in order to complete the curing process, for 24 hours after installation between 18-27°C at 55% RH. Avoid any walking after installation. Wait at least 4 hours before doing so.

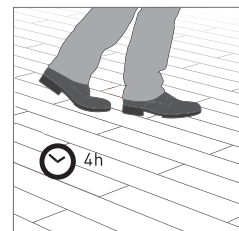
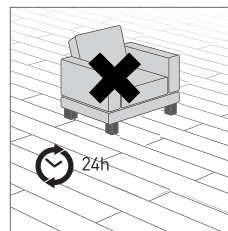

### Pipes/columns

Drill holes in the plank/tile, the diameter of the hole must be 8 mm larger than the diameter of the pipe. For fixed installations, like pipes, cut out the necessary piece in an angle of 45°. Glue the cut piece back into position and cover with pipe sleeves.

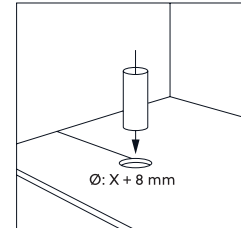

### Door frames

We strongly recommend adjusting the door frames to allow installation of the floor underneath the frames (to allow a good overlap with the floor). During the sawing, use a piece of plank/tile as a support (turned upside down) when modifying the door frames to the correct height (see illustration).

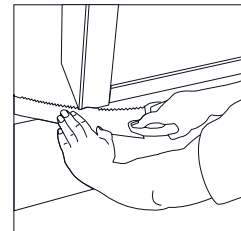

### Stair railing/other screwed objects

We recommend installing a wooden plank (slightly thicker than the floor) before fastening the stair railing/other screwed objects to the subfloor (see illustrations). This will allow a good overlap with the floor.

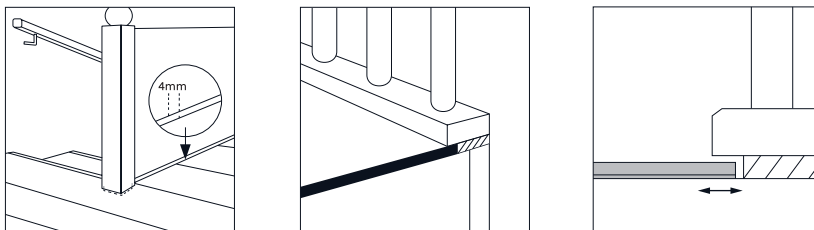

## 9. A perfect finish

Skirtings and profiles can be used for the finishing touch.

An adapted coloured sealant can be used to fill-in small gaps between planks or tiles after installation.

### T-profile (incl. U-profile)

Fix the U-profile to the subfloor and leave a gap of 8 mm to the floor areas. Click the T-profile in place after having installed the complete floor.

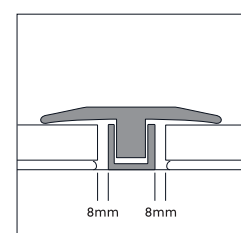

### Skirting

Use Clips when installing skirtings, to be able to remove them easily afterwards, if necessary. The clips should be placed with 50 cm intervals. Tip for cutting in corners: Support the skirting with clips on the backside when cutting, to make the correct angle on the skirting. The skirting can also be glued or nailed (with a high pressure brad tacker).

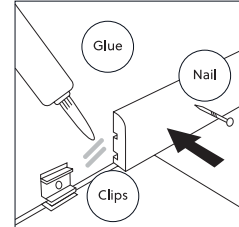

**N.B. :** Consider saving a few planks/tiles for any potential future repairs.

## 10. Care and maintenance

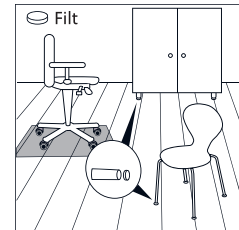
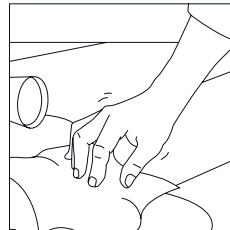
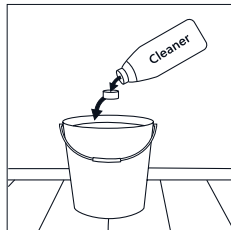
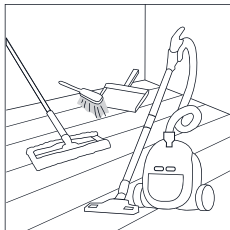

After installation it is required to maintain a room temperature of 18-25°C and a relative humidity level below 75% (optimum level 40-50%).

The LVT Glue Down floor is amazingly easy to clean :

- **Initial cleaning :** First remove all dirt and dust from the flooring with a brush or vacuum cleaner. Then clean with water and an appropriate neutral cleaning agent, at least twice and until the water stays clean.
- **Regular cleaning :** Vacuum or use a wet mop. As required, use a solution of clean water and mild detergent or domestic floor cleaning emulsion. Do not flood the floor or leave a puddle of water on the floor. Rinse thoroughly until the water stays clean and soak up residual water.

**NB :** Any unsuitable cleaning product may contain agents that damage resilient floor surfaces. The coating of the top-layer makes a specific treatment after installation unnecessary. LVT Glue Down cannot be polished or treated with products that contain wax or oil.

Clean up any spilled liquids immediately and never use steam cleaners on LVT.

To keep your floor in good condition, it is important to place non-rubber backed doormats at all entrances, to prevent dirt or grit on your floor. The use of doormats will eliminate abrasive particles driven by footwear and will reduce damage. Do not use rubber-backed mats or rubber pads, as long-lasting contact with rubber can cause permanent discoloration. Never place doormats on a wet floor.

Rolling (office chairs, furniture legs, home fitness appliances, etc. should be fitted with soft, non-rubber castors, to avoid permanent damage to your floor. Use a suitable desk mat.

We recommend the use of white felt pads or protective feet for items that contain rubber, such as chair legs, furniture legs, fitness appliances, etc. Use specific protection under heavy/sharp furniture to avoid indentation.

For more details, read our care and maintenance manual.

## **11. Warranty**

By following the above mentioned instructions, the longevity of the LVT Glue Down will be extended and the validity of the warranty ensured.

We refer to our warranty conditions for more info.

### **Legal information**

This document presents the general installation instructions, based on the latest available information. For the best result, and to ensure the validity of the guarantee, these instructions should be followed carefully. This document replaces all previous versions and is valid until further notice. This information is a representation of the technical knowledge at the time that this document was produced/published and may be amended, complemented, or replaced at any time. Please check the following website frequently for updates: [www.luxuryvinylflooring.org](http://www.luxuryvinylflooring.org)